

LEGEND	
	PLANNING APPLICATION BOUNDARY
	1.5M SCREEN WALL (SEE MATERIALS PLAN)
	Natural Stone Dwarf Wall
	1.5M CLOSE BOARDED FENCE
	1200mm PANEL FENCE (HA)
	1800mm Ht & Miss Fence
	1800mm PRIVACY PANEL (HA)
	REAR GATE
	AFFORDABLE RENT
	AFFORDABLE RENT PLUS
	SHARED OWNERSHIP
	Line of Horrois as temporary protection to the pos area.
	50mm Marshall's Keyblok non-permeable paving, Herringbone pattern.
	EXISTING HEDGEROWS TO BE RETAINED.
	EXISTING TREES TO BE RETAINED.
	Sheds provided as cycle storage for plots w/o garages. 2 No. 400x800mm high Sheffield style blue stands to be bolted in to concrete base through pre-cut hole in shed floor.
	Bin Storage area.
	Bin Collection Point.

Phase 2 Accomodation Schedule					
Type	House Type	Beds	SQFT	No.	
T1	X201 2 Bedroom Fog	2	724	7	
HO	X203 Holly	2	851	5	
HA	X305 Hazel	3	946	53	
SP	X307 Spruce	3	1095	16	
CY	X308 Cypress	3	1123	16	
T10	X310 Poplar	3	1276	16	
WI	X411 Willow	4	1475	4	
JU	X412 Juniper	4	1234	19	
CH	X413 Chestnut	4	1385	4	
AS	X414 Aspen	4	1387	13	
AL	X415 Alder	4	1527	27	
BI	X518 Birch	5	1808	10	
YE	X519 Yew	5	1894	4	
LI	X520 Lime	5	2084	5	
			18809	199	
Affordable housing					
1B(A)	1 Bedroom Apartment		507	3	
2B(A)	2 Bedroom Apartment		653	10	
2B	S224 2 Bedroom House		865	19	
3B	S325 3 Bedroom House		1022	9	
			3047	41	
Overall Total			21856	240	

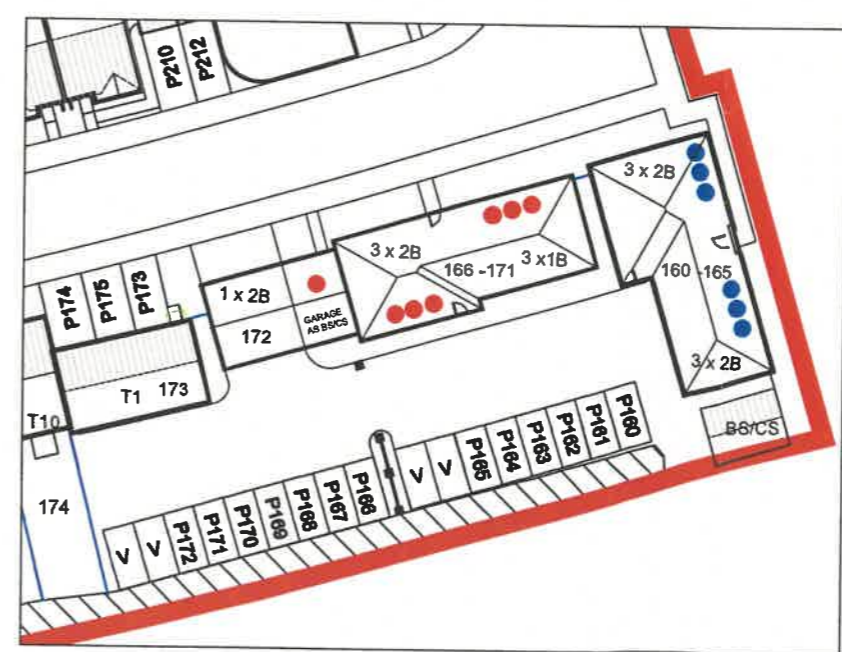

REV	DATE	DESCRIPTION	BY	CHK	APD
F	25.05.21	Rentplus / Affordable Rent Apartments 160-172 amended to separate units into separate apartment blocks.	AP	TB	TB
E	16.09.2019	Hawthorn House Type replaced with Holly to comply with space standards	DR		RE
D	05.09.2019	Eastern Boundary RPA area hatched and note added "land to be transferred to Man. Co"	HP		DAR
C	18.07.2019	Rear footpath added to plot 247 in accordance with highways comments.	HP		DAR
B	27.06.2019	Layout amended in accordance with planning Initial consultation.	HP	RB	DAR
A	25.09.2018	INITIAL ISSUE	MVR	RB	DAR

DRAWING STATUS: PLANNING APPLICATION		
PROJECT: Callington Road, Tavistock.		
TITLE: Phase 2, Planning Layout - Overall		
PROJECT No:	DRAWING No:	REV:
0135	02-203	F
SCALE @ A2:		

Bovis Homes Limited
 South West Region.
 Heron Road,
 Sowton Industrial Estate,
 Exeter,
 EX2 7LL
 Tel:
 Fax:
 DX: 314701 Exeter 38